

## Package contents (parts are not to scale):

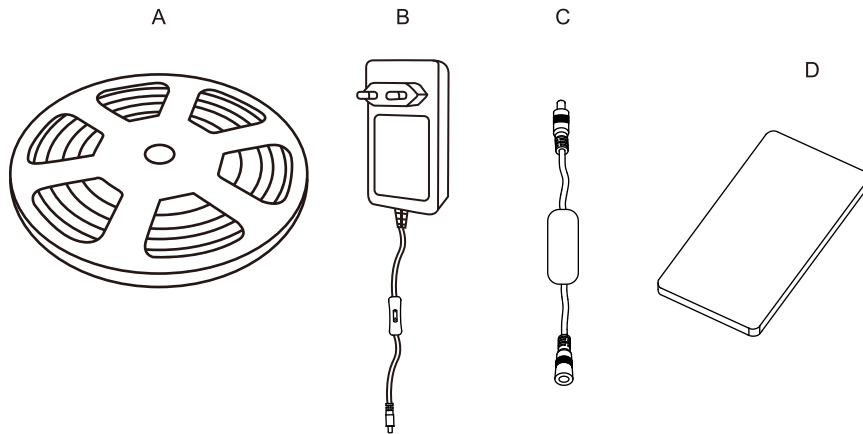

Part	Description	Quantity
A	Flexible led strip(3M)	1
B	LED driver plug	1
C	LED controller	1
D	Remote control unit	1

## Cautions

1. Before power on the production, ensure that all wiring is correct to avoid damage to the lighting fixtures due to wiring errors.
2. Good heat dissipation conditions can prolong the service life of LED controllers. Please install the product in a well ventilated environment.
3. To ensure the effectiveness of remote control, please use it within the specified distance and avoid obstruction.
4. Please do not install or use such products in situations with lightning, strong magnetic fields, or high voltage.

## FLEXIBLE LED STRIP 3M

Art Nr. 11000000068

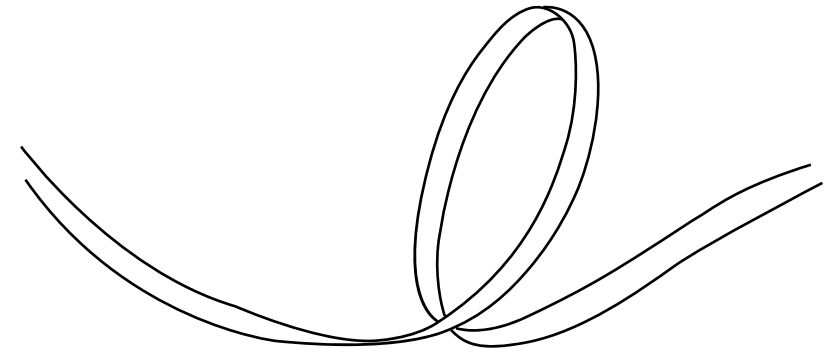

[www.lampehuset.no](http://www.lampehuset.no)

## Diagram of Easy Set components

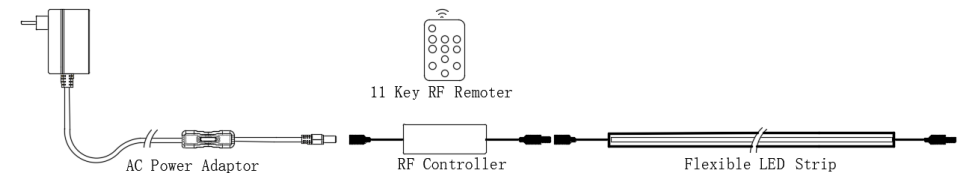

## Operation Instructions

1. Open the package and check to see if any parts are broken. If in good condition, connect the power supply, light strip and controller according to the picture above.
2. Plug the power adapter input plug into the power supply socket , the light strip will light up, you can use the RF remote control light strip to adjust the brightness and mode .The function of the remote control button is illustrated as follows picture.

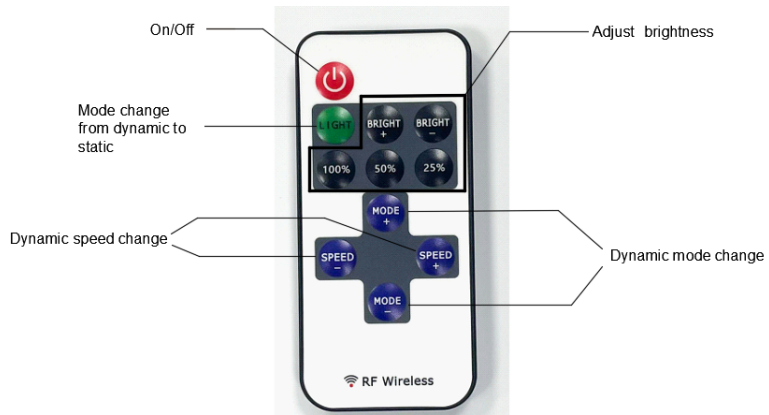

## Product parameters

### Adaptor parameters

Input: 100-240V 50/60hz 0.4A Max  
 Output: 24v 1A 24W  
 Waterproof rating: IP20

### Led strip parameters

Input voltage:DC24V  
 Luminous flux: 650LM/M  
 CRI>90 power: 18W  
 CCT:3000K cutting unit:31.25mm  
 Waterproof rating: IP65

### Controller parameters

Power supply voltage:DC5-24V  
 Remote frequency: 433MHZ  
 Dynamic modes: 8  
 Remote distance:15M at open area  
 Output: 1CH 6A Max  
 brightness level:10 levels

## DIY installation guide

### Schematic diagram of cutting

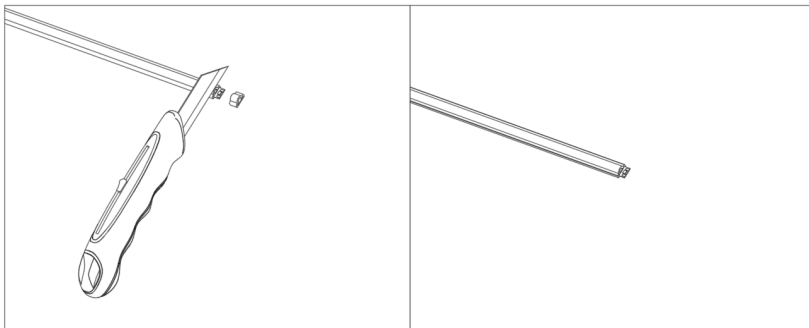

Use a knife to strip approximately 5 mm of the outer silicone layer from the lamp strip (pay attention to the force and angle to avoid damaging the internal PCB)

## DIY installation guide (continued)

### Middle Connector Cable Installation

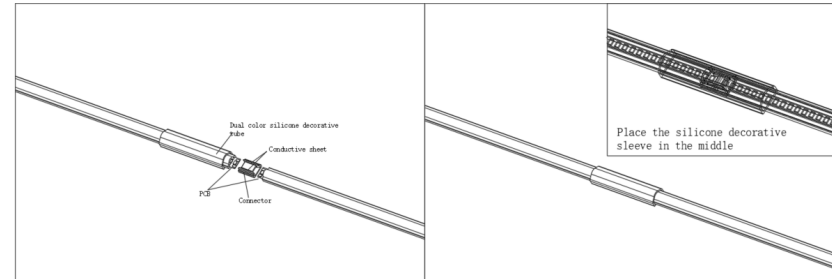

1. Insert the two-color silicone decorative sleeve onto the light strip.
2. Insert the corresponding LED board into the connector. Use pliers to press the metal sheet until it is flush with the glue housing, ensuring there are no bulges.
3. Place the two-color silicone plug in the middle position and secure it to the light strip with adhesive (ensure the adhesive is fully filled).

### Double end Connector Cable Installation

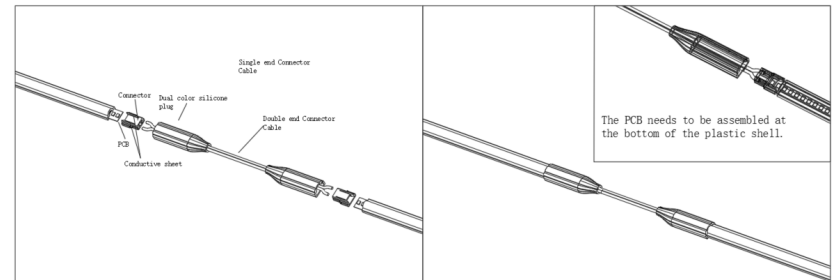

1. Insert the LED board into the connector, and connect the white and two-color cables to their designated ports in the connector according to the specified requirements.
2. Use pliers to press the metal sheet so that it becomes flush with the glue housing surface, making sure there are no raised areas or bulges.
3. With adhesive applied internally, fix the two-color silicone plug to the light strip, taking care to fill the adhesive completely.