

## Package contents (parts are not to scale):

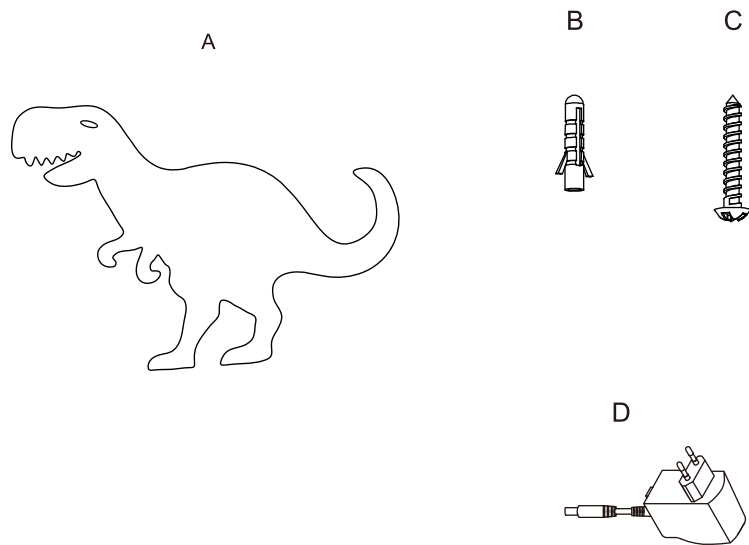

Part	Description	Quantity
A	Fixture body	1
B	Wall expansion particle( $\Phi 8 \times L 37 \text{mm}$ )	2
C	Cross pan head self-tapping screw (M4*L32mm)	2
D	LED adaptor plug	1

## Light source

Max. 230V LED 7W 300Lumen 3000K (Dimmable)

(Lamp gurantee: 3 years,LED lifetime: 30000 hours)

## Care and Cleaning

### EXTERIOR MAINTENANCE

1. To clean the outside of the fixture, use a dry or slightly dampened clean cloth (use clean water, never a solvent) to wipe the surface of the fixture.
2. Do not use any cleaners with chemicals, solvents or harsh abrasives. Use only a dry soft cloth to dust or wipe carefully.

## INTERIOR WALL LAMP

Art Nr. 11000000249

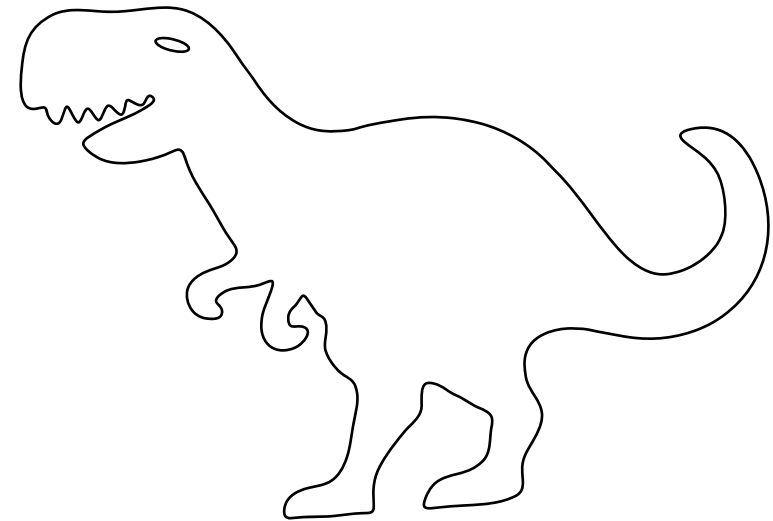

## Pre-Installation

### PLANNING THE INSTALLATION

Read all instructions before assembly and installation. Before starting installation of the fixture or removal of a previous fixture, disconnect the power by turning off the circuit breaker or by removing the fuse at the fuse box. To avoid damaging this product, assemble it on a soft, non-abrasive surface such as carpet or cardboard.

### TOOLS REQUIRED

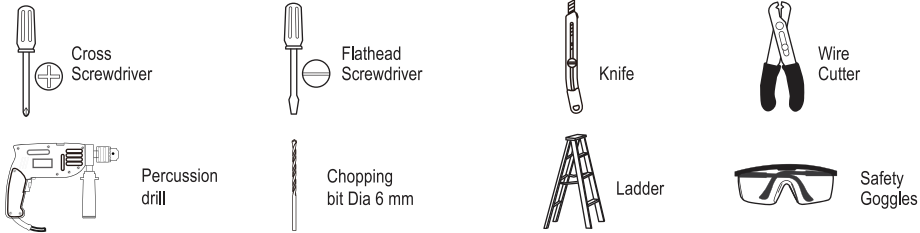

## Installation

### Step 1.

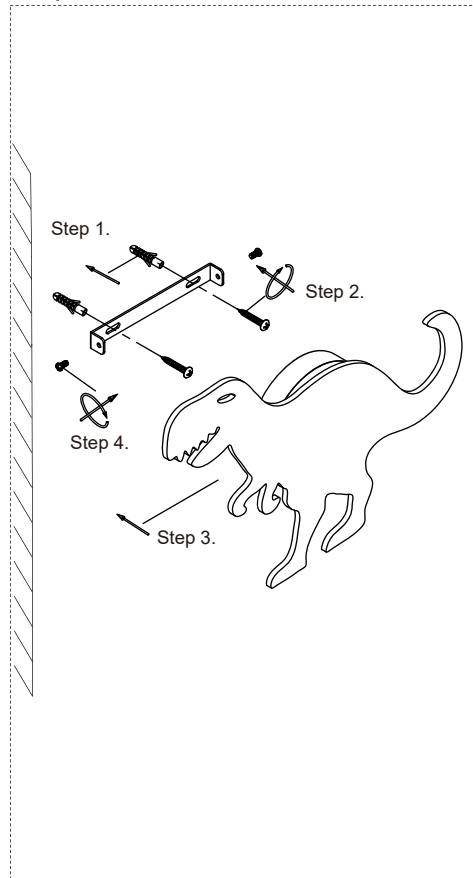

### Step 2.

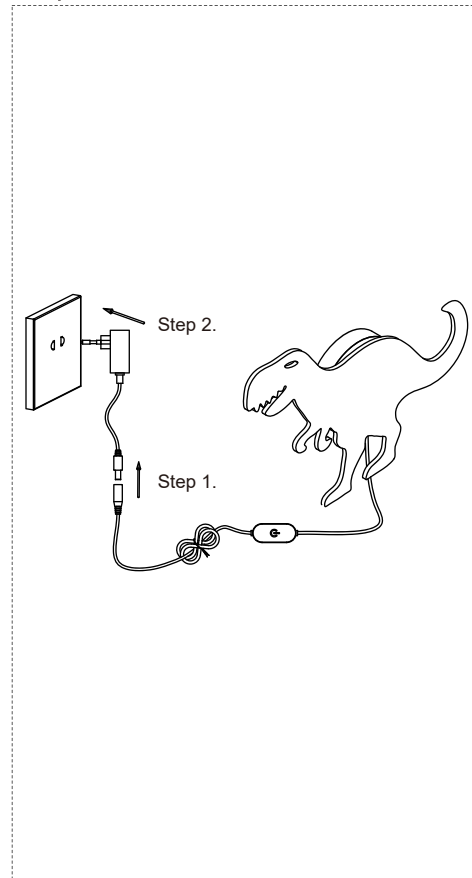

## Installation (continued)

Mounting bracket size (Unit millimeter)

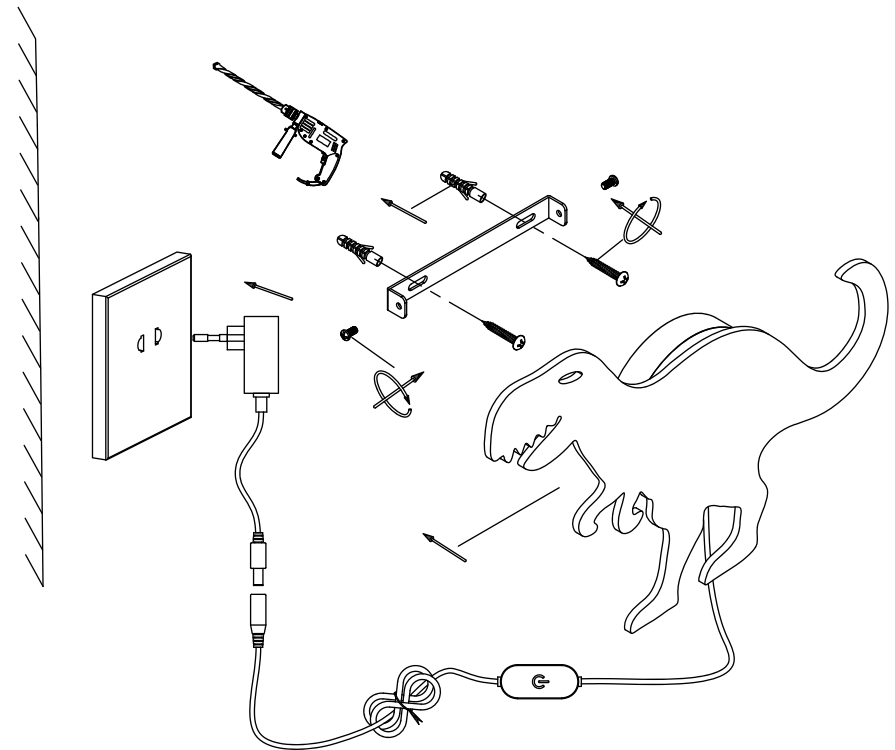
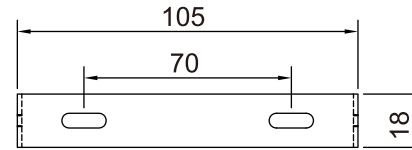

## Operation

- Turn on power at the circuit breaker or fuse box.
- Turn the light switch on to activate the fixture.