

## Package contents (parts are not to scale):

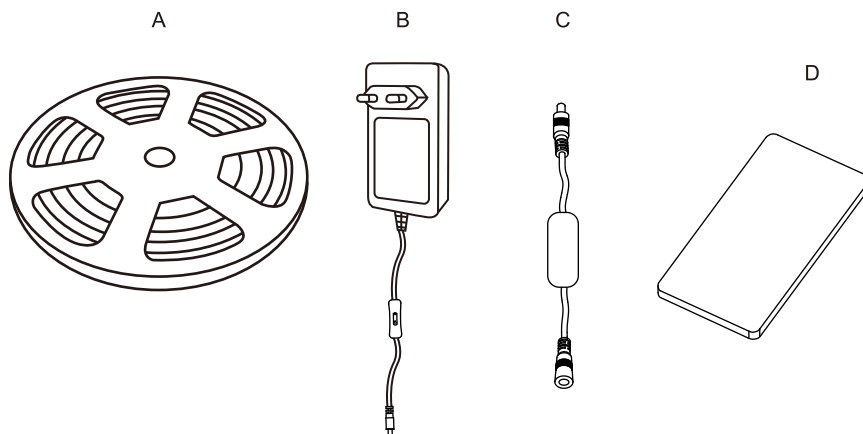

Part	Description	Quantity
A	Flexible led strip	1
B	LED driver plug	1
C	LED controller	1
D	Remote control unit	1

## Cautions

1. Before power on the production, ensure that all wiring is correct to avoid damage to the lighting fixtures due to wiring errors.
2. This product are not waterproof and should be protected from sunlight and rain. If installed outdoors, please use a waterproof box.
3. Good heat dissipation conditions can prolong the service life of LED controllers. Please install the product in a well ventilated environment.
4. To ensure the effectiveness of remote control, please use it within the specified distance and avoid obstruction.
5. Please do not install or use such products in situations with lightning, strong magnetic fields, or high voltage.

## FLEXIBLE LED STRIP

Art Nr. 06007-003-00

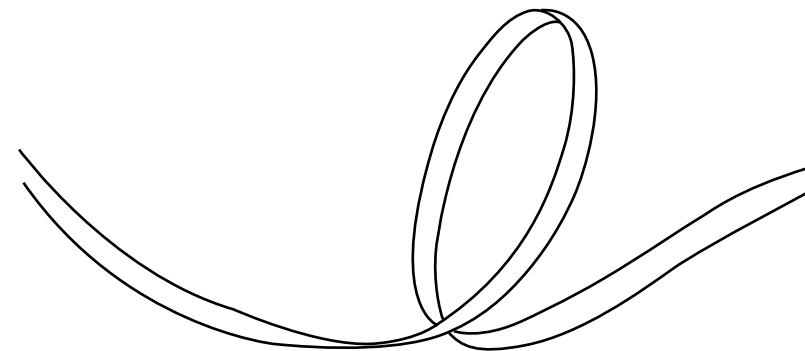

[www.lampehuset.no](http://www.lampehuset.no)

## Diagram of Easy Set components

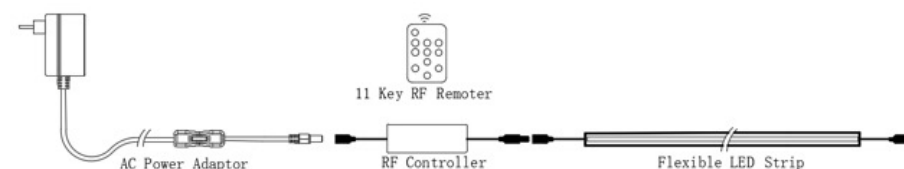

## Operation Instructions

1. Open the package and check to see if any parts are broken. If any parts are broken. If in good condition, connect the power supply, light strip and controller according to the picture above.
2. Plug the power adapter input plug into the power supply socket , the light strip will light up, you can use the RF remote control light strip to adjust the brightness and mode .The function of the remote control button is illustrated as follows picture.

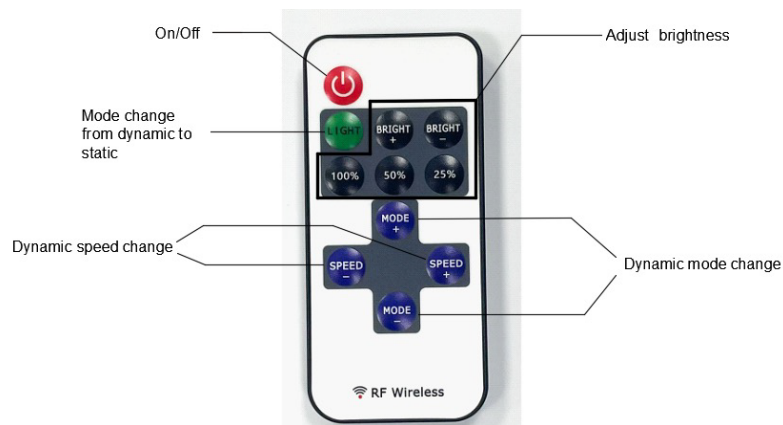

## Product parameters

### Adaptor parameters

Input Voltage: 220-240V AC 50/60HZ 0.4A Max  
Output Voltage: 24V DC 1A 24W  
Waterproof rating: IP20

### Led strip parameters

Input Voltage: DC 24V  
Lumen: 380Lm/M  
LED Color: 3000K  
CRI>90  
Dimension: 3000\*8mm

### Controller parameters

Power supply voltage: DC5-24V  
Output: 1CH 6A Max  
Dynamic modes: 8  
Remote distance: 15M at open area

## DIY Installation guide

(The cutting & connecting is not the essential to this item, please contact to source Art Nr. 10488-014-00 when it is necessary)

### Schematic diagram of cutting

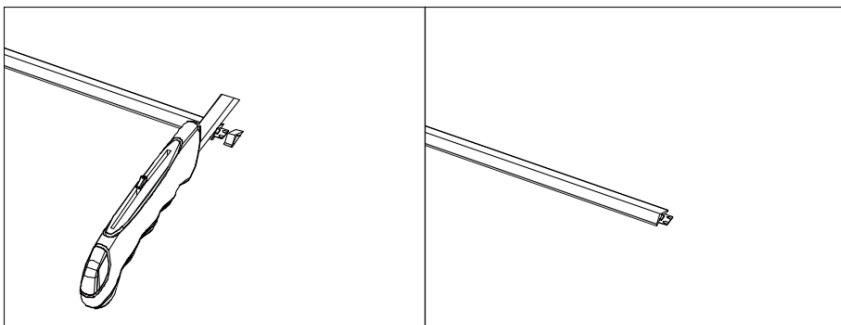

Strip the silicone lamp strip about 5mm with a knife (Do not damage the PCB)

## Single end Connector Cable Installation

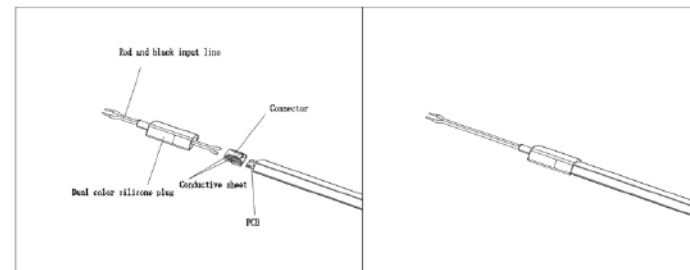

1. Insert the stripped PCB into the connector until the bottom, and insert the red and black cables into the connector as required
2. Use pliers to press the metal sheet to make sure the metal sheet is flush with the glue shell and no bulges
3. Two color silicone plugs are fixed to the light strip with adhesive inside (ensure that the adhesive is fully filled)

## Middle Connector Cable Installation

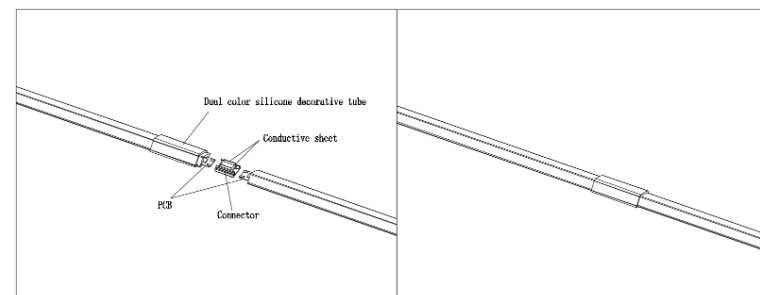

1. Insert the two-color silicone decorative sleeve onto the light strip
2. Insert the corresponding light board into the connector, Use pliers to press the metal sheet to make sure the metal sheet is flush with the glue shell and no bulges
3. Two color silicone plugs are fixed to the light strip with adhesive inside (ensure that the adhesive is fully filled)

## Double end Connector Cable Installation

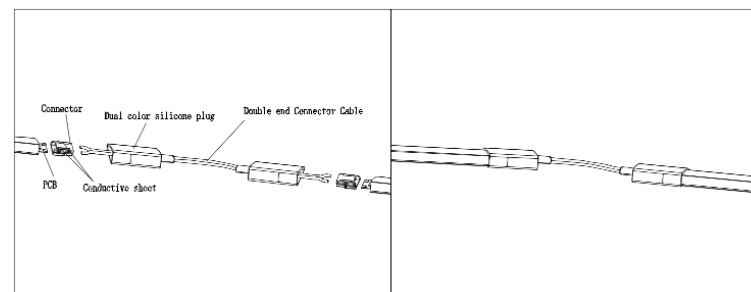

1. Insert the indicator board into the connector, and insert the red and black cables into the connector as required
2. Use pliers to press the metal sheet to make sure the metal sheet is flush with the glue shell and no bulges
3. Two color silicone plugs are fixed to the light strip with adhesive inside (ensure that the adhesive is fully filled)