

Package contents (parts are not to scale):

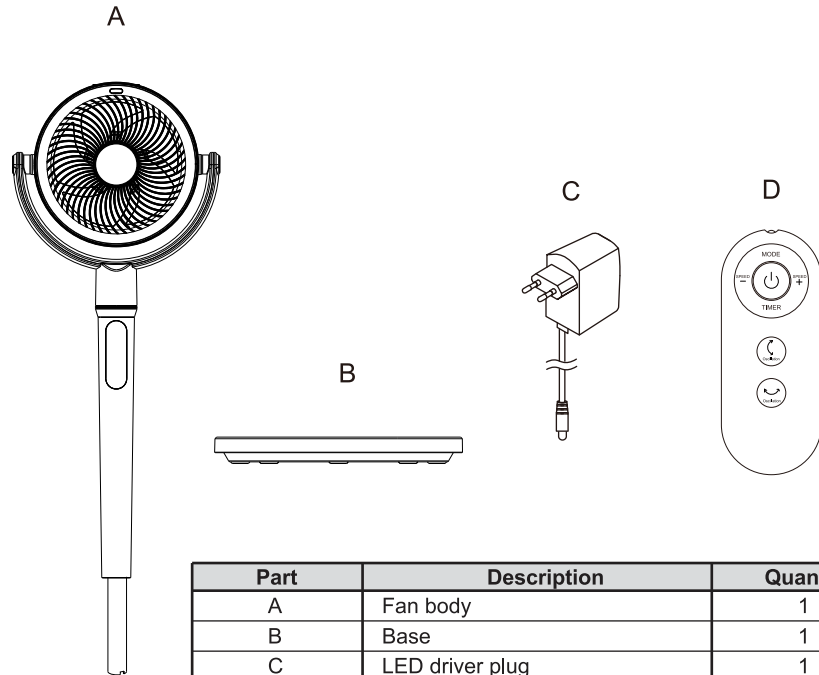

Part	Description	Quantity
A	Fan body	1
B	Base	1
C	LED driver plug	1
D	Remote control unit	1

1. Use in a dry place. Free of excessive humidity.
2. To keep the fan clean, wipe away the dirt with a cloth moistened by soapy water, then dry it with another clean dry cloth.
3. Do not use any harsh cleaners.
4. Pack the fan in a plastic bag before storage, then store it in a dry place.
5. When reassembling the fan, make sure to follow instructions below for how to assemble.

Care, Cleaning & Storage

- Keep the fan clean.
- Ensure that the fan is switched off from the supply mains before any cleaning. Plastic parts should be cleaned with a moist cloth. Thoroughly remove water film with dry cloth.
- Avoid use of gasoline, benzene and other harsh cleaners on the plastic parts.
- Always store the fan in a cool dry location.

12 INCH Air CIRCULATING STANDING FAN

Art Nr. 85324-110-50

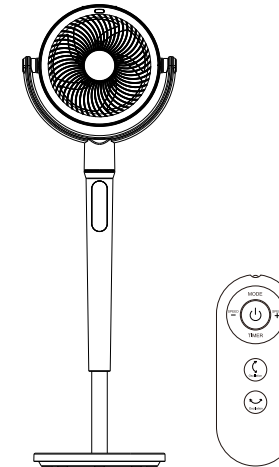

CAUTION

1. This appliance is not intended for use by persons (including children) with reduced physical, sensory, or mental capabilities, or lack of experience and knowledge, unless they have been given supervision or instruction concerning use of the appliance by a person responsible for their safety. Children should be supervised to ensure that they do not play with the appliance.
2. If the supply cord is damaged, it must be replaced by the manufacturer, its service agent, or similarly qualified persons in order to avoid a hazard.
3. DO NOT use this unit for functions other than those described in this instruction manual
4. Do NOT tilt the unit. Always keep in upright. Position on a flat and stable surface, where it cannot be easily knocked over. Take extra care when operating
5. Do NOT connect the unit unless it is completely assembled
6. Do NOT use the unit in a wet room, such as a bathroom or laundry
7. Do NOT touch the unit with wet hands or bare feet
8. DO NOT use the unit in the presence of inflammable substances or vapor such as alcohol, insecticides, petrol etc
9. Do NOT use the mains plug to start and stop the unit
10. Do NOT pull the supply cord or place it near a heat source. Always unwind the cord completely to avoid overheating
11. Do NOT insert or allow foreign objects to enter the grille openings as this may cause damage to the appliance and/or user.
12. Do NOT conduct repairs on this unit. It has been built in accordance with relevant safety and performance standards. An electrical specialist must carry out all repairs
13. DO NOT place or wind the power cord around the device. During the operation of the device the power cord should not come in contact with the running fan
14. DO NOT cover the device
15. DO NOT place the power cord under the carpet as this will cause the cable to overheat. Do not cross the power cord across any passageway to avoid tripping hazard or damage to the device. This unit is intended for indoor use only
16. ALWAYS unplug the power supply from the mains before maintenance or cleaning
17. ALWAYS Ensure that the fan is switched off from the supply mains before removing the guard.
18. ALWAYS use the switch on the control panel to start and stop the unit
19. ALWAYS keep a clearance of at least 200mm from walls furniture and curtains
20. ALWAYS turn off and unplug the unit when not in use. This device is only for indoor household use. Keep all packaging and parts secure away from children.

PARTS DIAGRAM

VOLTAGE	POWER
AC100V-240V DC12V	30W

1. Front grill	7. Motor head
2. Blade lock	8. Fan body fixing knob
3. Blade	9. Telescopic pole
4. Motor circulating frame	10. Base
5. Back grill	11. Extra base
6. Speed receiver panel	12. Base fixing screws and bolts

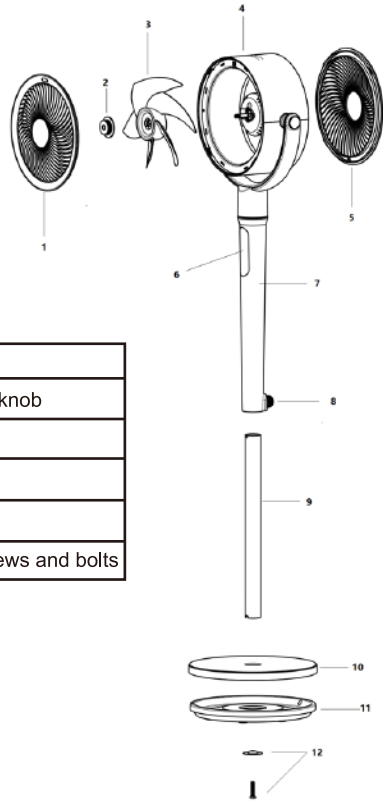

ASSEMBLY

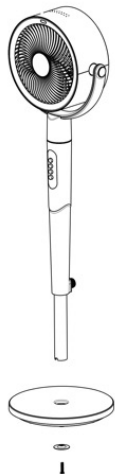

1. Unpack the box to take out the fan body and motor head. Then pull out the Telescopic pole (9) to maximum length (it can be adjustable). Insert the pole (9) into the base (10).
2. Connecting the pole (9) with the extra base (11) at the bottom of the base (10) by fastening the screws and bolts sets (12).

OPERATION PANEL

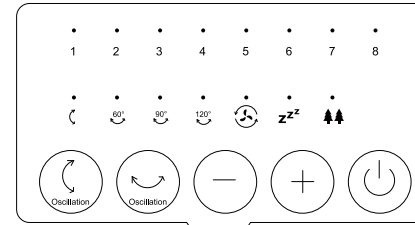

Noise level:

Low gear(1-2-3):36/38/40dB

Mid-range(4-5):45/47dB

High-end(6-7-8):52/54/61dB

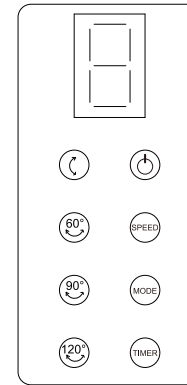

- Button: This button can be used to turn the fan ON/OFF.
- “-” to decrease the speed, “+” to change the speed from low to high speed. Total 1-8 speeds option.
- **TIMER**: touch this button to set the fan off timer from 1-8 hours.
- **Mode**: This button can be used to change the modes from Normal/Natural/Sleep.
- Normal: The fan will be operated in constant speed depending on the speed selected.
- Natural: The fan will simulate a natural breeze mode by cycling On and OFF as in nature. If the fan is set to high speed, the fan speed cycles through a mixed selection of low, medium and high speed. If the fan is set to medium speed, the fan speed cycles through a mixed selection of medium and low speed. If the fan is set to low speed, the fan will follow a switching cycle similar to 5 seconds low speed and 5 seconds off.
- Sleep: In this mode the fan simulates a soft, gentle breeze of air, suitable for resting. Sleep mode will create wind patterns that are same as the natural mode wind patterns. However, if the fan is set to high or medium speed, the pattern will drop a speed level after approximately 30 minutes. As an example, if the high speed is selected, the fan will follow the same pattern as the high speed natural mode for the first 30 minutes and then it will change the pattern same as the medium speed natural mode. After approximately further 30 minutes the fan will change the pattern to low speed natural mode until the fan is manually turned off.
- This Icon can be used to make the fan up and down oscillate in 90 degree.
- This Icon can be used to make the fan left and right oscillate in 60, 90, 120degree option.

REMOTE CONTROL

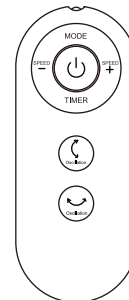

choose to operate this fan via the control panel or the included remote control

The buttons on the remote control have the same functions as the control panel on the fan. The sensor of the remote control must be pointed at the fan receiver to operate properly. To use the remote, make sure that the fan is plugged into the power supply.

Note: remote controller is not waterproof and not intended for children use. The remote control supplied with coin type battery. Battery can be removed and replaced after running out.

DANGER IF SWALLOWED!!