



09120-000-53  
09120-000-71

## Specification:

Power: 0.2W	Battery capacity: 400mAh
Lumen: 15LM	Color Temp: 2700K

## Introduction:

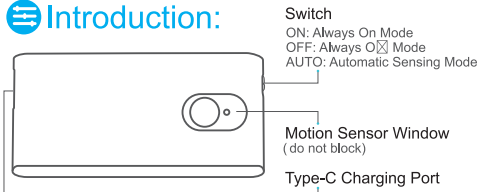

### Automatic Sensing Mode:

The light automatically turns on when the sensor detects human activity in a dark environment (**less than 20 lux**) and automatically turns off after 20 seconds if no further activity is detected.

Note: Whenever switched to AUTO mode, regardless of whether it's dark or bright, the light will turn on, stay lit for 10 seconds, and then officially enter automatic sensing mode.

## Installation:

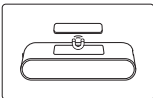

Place the iron plate on the black magnetic area of the lamp.

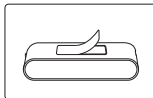

Remove the protective film from the double-sided tape.

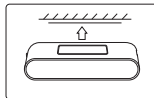

Stick it on and press firmly.  
(To ensure optimal adhesion, choose a smooth surface and clean it thoroughly)

It can also be installed directly on a magnetic metal surface

## Warm Tips:

1. Please use a 5V charger or mobile power bank to charge this product when using it for the first time.
2. Do not install two motion sensor lights too close to each other as the brightness of one may prevent the other from lighting up.

## FAQs:

Q1: Why is the sensor not responding well? Why do I need to get close or wave my hand to activate it?

- A: The environment might not be dark enough (less than 20 lux). Getting closer or waving your hand can reduce the surrounding light, enabling the sensor to work.
- B: The sensor head has a detection angle of 120°. Ensure the activity area is within this angle during installation.

Q2: Why is the light not charging?

- A: Replace the charging cable and adapter, as poor contact might be causing the issue.
- B: Contact our after-sales team for a one-year warranty. They will provide a solution.

